

- PBW type cable glands for use with all armoured cables.
- Suitable for indoor applications.
- Providing mechanical cable retention and electrical continuity via armour wire termination.
- Cable gland kit consists:
 - PVC - Brass Gland, Steel Locknut, Earhtag & PVC Shroud.
 - LSZH - Brass Gland, Steel Locknut, Earhtag & LSZH Shroud.

Technical Specification:

Threading: Metric

Standard: BS 6121:2005 – Under Certification

IP Rating: IP 2X

Material Grade: Brass CuZn39Pb3 (CW614N)

Cable Type: Steel Wire Armour (SWA)

Continuous Operating Temperature: **PVC:** -20°C to +90°C

LSZH: -20°C to +130°C

Cable Gland Selection Table:

Cable Gland Size	Entry Thread 'C'	Minimum Thread Length 'G'	Cable Bedding Diameter 'A'	Overall Cable Diameter 'B'	Armour Range		Across Flat 'E'	Across Corners 'D'	Nominal Protrusion Length 'F'	Ordering Reference PVC	Ordering Reference LSZH
			Max	Max	Min	Max	Max	Max			
20S	M20	10	11.8	15.8	0.9	1.25	22.0	24.0	16.0	PBW20S PACK	PBW20SLSZH PACK
20	M20	10	13.8	19.5	0.9	1.25	26.0	28.0	17.0	PBW20 PACK	PBW20LSZH PACK
25	M25	10	19.8	27.0	1.25	1.6	32.8	36.5	18.0	PBW25 PACK	PBW25LSZH PACK
32	M32	10	26.4	33.5	1.6	2.0	40.2	44.0	21.0	PBW32 PACK	PBW32LSZH PACK
40	M40	15	32.4	40.1	1.6	2.0	49.5	53.0	23.0	PBW40 PACK	PBW40LSZH PACK
50S	M50	15	38.0	46.3	2.0	2.5	57.0	62.5	24.0	PBW50S PACK	PBW50SLSZH PACK
50	M50	15	44.0	52.6	2.0	2.5	61.8	68.8	25.0	PBW50 PACK	PBW50LSZH PACK
63S	M63	15	49.0	61.5	2.5	2.5	70.0	76.0	26.0	PBW63S PACK	PBW63SLSZH PACK
63	M63	15	56.2	65.5	2.5	2.5	75.0	84.0	28.0	PBW63 PACK	PBW63LSZH PACK
75S	M75	20	62.0	71.6	2.5	2.5	85.0	93.0	36.0	PBW75S PACK	PBW75SLSZH PACK
75	M75	20	69.0	78.0	2.5	2.5	90.0	99.0	36.0	PBW75 PACK	PBW75LSZH PACK
90	M90	20	79.0	90.0	3.15	3.15	104.5	114.0	52.0	PBW90 PACK	PBW90LSZH PACK

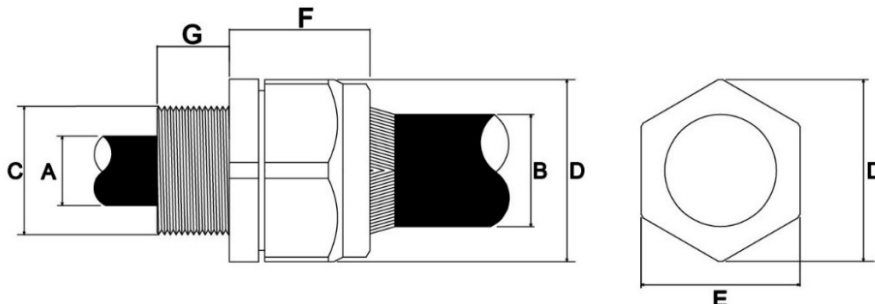

Specialised Wiring Accessories (SWA): Abbey Mills, Charfield Rd, Kingswood, Gloucestershire, GL12 8RL PBW.V03.22